

Modified Bassin Anticipation Timer User's Manual



P.O. Box 5729

Lafayette, IN 47903 USA

Tel: (765) 423-1505 • (800) 428-7545

Fax: (765) 423-4111

info@lafayetteinstrument.com

www.lafayetteinstrument.com

Model 35580 Modified Bassin Anticipation Timer Setup

*see instructions
supplied with
tripod for release
mechanism of shoe

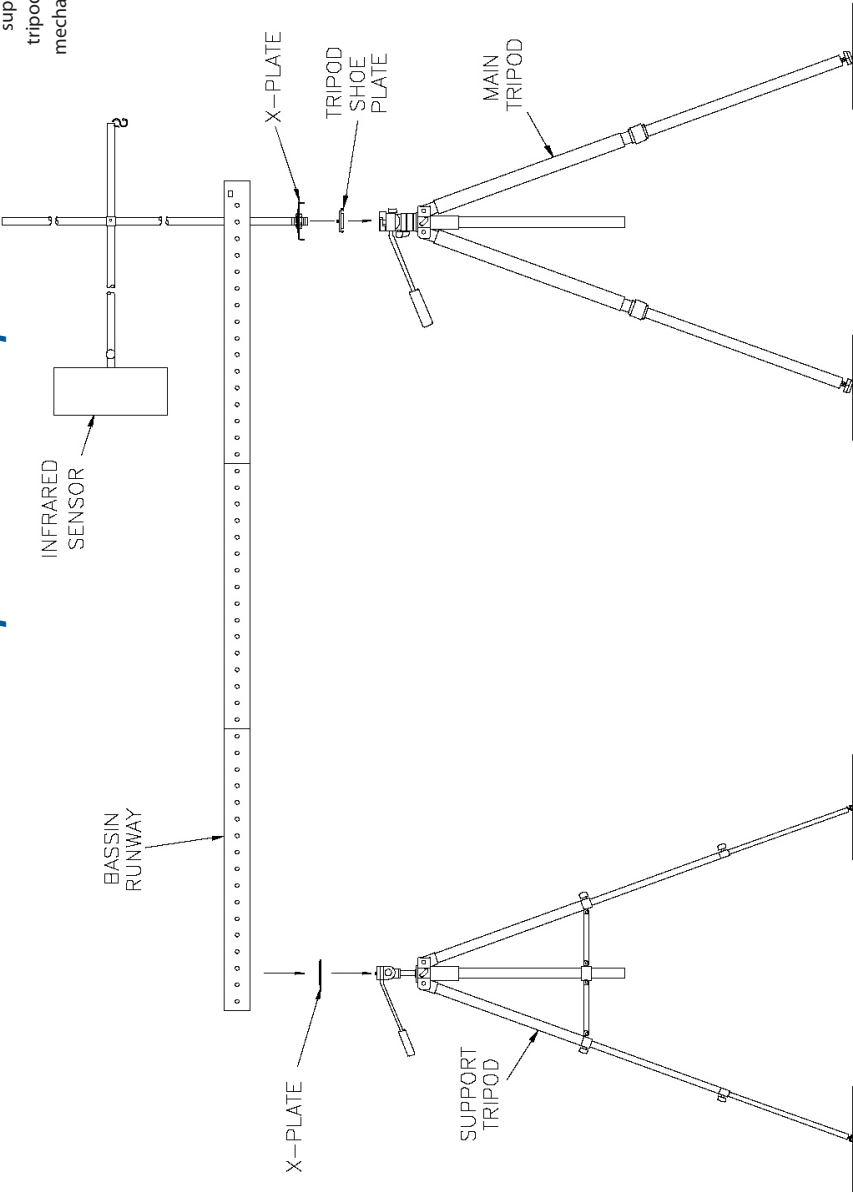

Model 35580 Modified Bassin Anticipation Timer Setup

Instructions

1. If it is not already attached, attach the pipe with the crossover fitting to the large X-Plate Assembly as shown with the small allen wrench.

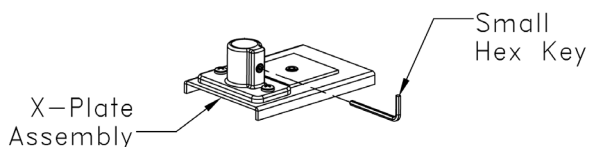

2. Remove the Tripod Shoe Plate from the Provista 6510 tripod.



3. Attach the shoe plate as shown.

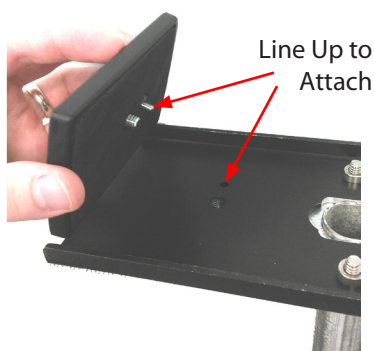

Turn Clockwise to Tighten

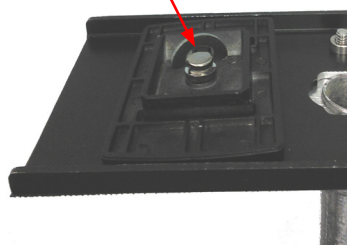

Lafayette Instrument Modified Bassin Anticipation Timer

4. Make sure the shoe attachment handle is as shown before reattaching.

Turned Out and
Popped Up



5. Move the lever arm out and up out of the way for reattaching the shoe plate. The adjustment knob may have to be removed completely temporarily.



6. Reattach the shoe plate as shown.



7. Loosen the crossover fitting with the large allen wrench and slide the hook end of the additional pipe through as shown.

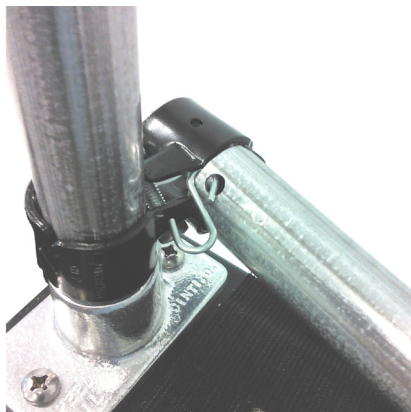

8. The height can be adjusted at this point. Make sure not to drop the horizontal pipe while adjusting the height. Both the vertical and horizontal sliding become loose at the same time.

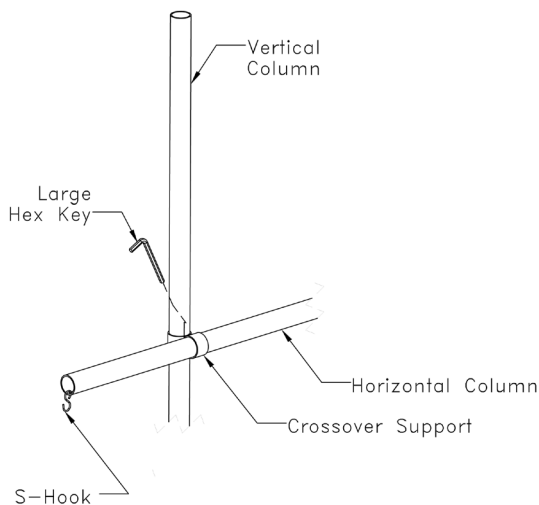

Lafayette Instrument Modified Bassin Anticipation Timer

9. Attach the chain at the hook and below the tripod at the loop of cloth. The chain should cross under the tripod for maximum stability. The crossover fitting can be raised to make the chain more taught. To adjust the tripod, see the photos below. If it is difficult to keep steady, come back to this step once the Bassin Runway is attached.



10. Unscrew the Sensor Mount Holding Knob to remove the Sensor Mount from the Horizontal Column (shown in the diagram). The sensor mount can be screwed into the Infrared Sensor Box and then be attached back to the Horizontal Column with the Sensor Mount Holding Knob.

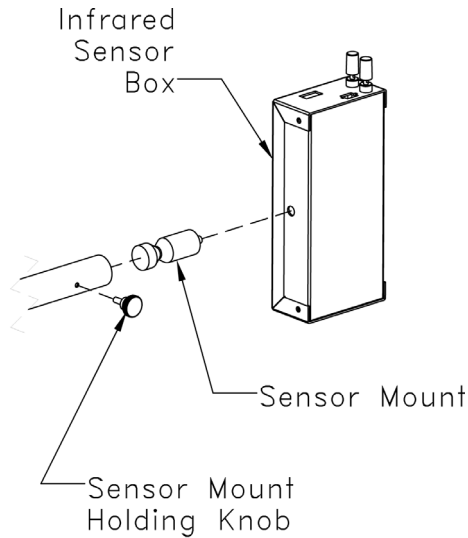

11. The small square plate with Velcro should be attached to the smaller tripod in a similar manner as the large plate was attached to the Provista 6510.
12. Space both tripods and adjust heights for level seating of the Bassin Runway.
13. The reflector is placed on the ground just below the Infrared Sensor Box.
14. Turn on and align the Infrared Sensor Box opposite the reflector and lock into position when output light is illuminated.
15. Connect one end of the IR runway cable with the red and black banana plugs to the Infrared Sensor Box. Connect the other end of the cable to the finish end panel of the Basin Runway.
16. Connect one end of the start runway cable to the rear of the control box and the other end to the start end of the Bassin Runway.
17. Plug the power cord into an AC outlet. Turn on the power switch and adjust runway speed and warning time to desired setting. The Modified Bassin Timer is now ready for use.

Note: Please refer to the 35575 Basic Bassin Anticipation Timer and the 63501IR Infrared Control user's manuals.

Terms and Conditions

LIC Worldwide Headquarters

Toll-Free: (800) 428-7545 (USA only)

Phone: (765) 423-1505

Fax: (765) 423-4111

Email: sales@lafayetteinstrument.com

export@lafayetteinstrument.com (Outside the USA)

Mailing Address:

Lafayette Instrument Company

PO Box 5729

Lafayette, IN 47903, USA

Lafayette Instrument Europe:

Phone: +44 1509 817700

Fax: +44 1509 817701

Email: eusales@lafayetteinstrument.com

Phone, Fax, Email or Mail-in Orders

All orders need to be accompanied by a hard copy of your purchase order. All orders must include the following information:

- Quantity
- Part Number
- Description
- Your purchase order number or method of pre-payment
- Your tax status (include tax-exempt numbers)
- Shipping address for this order
- Billing address for the invoice we'll mail when this order is shipped
- Signature and typed name of person authorized to order these products
- Your telephone number
- Your email address
- Your FAX number

Domestic Terms

There is a \$50 minimum order. Open accounts can be extended to most recognized businesses. Net amount due 30 days from the date of shipment unless otherwise specified by us. Enclose payment with the order; charge with VISA, MasterCard, American Express, or pay COD. We must have a hard copy of your purchase order by mail, E-mail or fax. Students, individuals and private companies may call for a credit application.

International Payment Information

There is a \$50 minimum order. Payment must be made in advance by: draft drawn on a major US bank; wire transfers to our account; charge with VISA, MasterCard, American Express, or confirmed irrevocable letter of credit. Proforma invoices will be provided upon request.

Exports

If ordering instrumentation for use outside the USA, please specify the country of ultimate destination, as well as the power requirements (110V/60Hz or 220V/50Hz). Some model numbers for 220V/50Hz will have a "C" suffix.

Quotations

Quotations are supplied upon request. Written quotations will include the price of goods, cost of shipping and handling, if requested, and estimated delivery time frame. Quotations are good for 30 days, unless otherwise noted. Following that time, prices are subject to change and will be re-quoted at your request.

Cancellations

Orders for custom products, custom assemblies or instruments built to customer specifications will be subject to a cancellation penalty of 100%. Payment for up to 100% of the invoice value of custom products may be required in advance. Cancellation for a standard Lafayette Instrument manufactured product once the product has been shipped will normally be assessed a charge of 25% of the invoice value, plus shipping charges. Resell items, like custom products, will be subject to a cancellation penalty of 100%.

Exchanges and Refunds

Please see the cancellation penalty as described above. No item may be returned without prior authorization of Lafayette Instrument Company and a completed Return Form. A copy of the Return Form or your assigned Return # (you will receive this via email after submitting the form) **must be included with the returned goods**. The merchandise should be packed well and fully insured. Unopened merchandise may be returned prepaid within thirty (30) days after receipt of the item and in the original shipping carton. Collect shipments will not be accepted. Returned products must be in saleable condition, and credit is subject to inspection of the merchandise.

Repairs

Instrumentation may not be returned without prior authorization by Lafayette Instrument Company and a completed Return Form. When you

complete the Form, or call Lafayette Instrument, you will receive a Return #. Your Return # number will be good for 30 days. Address the shipment to:

Lafayette Instrument Company

3700 Sagamore Parkway North

Lafayette, IN 47904, USA.

Shipments cannot be received at the LIC PO Box. Items should be packed well, insured for full value, and returned along with a copy of the Return Form or the Return #. An estimate of repair will be given prior to completion ONLY if requested in an enclosed cover letter. We must have a completed purchase order by mail or fax, or repair work cannot commence for non-warranty repairs.

Damaged Goods

Damaged instrumentation should not be returned to Lafayette Instrument prior to a thorough inspection. If a shipment arrives damaged, note damage on delivery bill and have the driver sign it to acknowledge the damage. Contact the delivery service, and they will file an insurance claim. If damage is not detected at the time of delivery, contact the carrier/shipper and request an inspection within 10 days of the original delivery. Please call the Lafayette Instrument Customer Service Department for repair or replacement of the damaged merchandise.

Limited Warranty

Lafayette Instrument Company warrants equipment manufactured by the company to be free of defects in material and workmanship for a period of one year from the date of shipment, except as provided hereinafter. The original manufacturer's warranty will be honored by Lafayette Instrument for items not manufactured by Lafayette Instrument Company, i.e. resell items. This assumes normal usage under commonly accepted operating parameters and excludes consumable products.

Warranty period for repairs or used instrumentation purchased from Lafayette Instrument is 90 days. Lafayette Instrument Company agrees either to repair or replace, at its sole option and free of part charges to the customer, instrumentation which, under proper and normal conditions of use, proves to be defective within the warranty period. Warranty for any parts of such repaired or replaced instrumentation shall be covered under the same limited warranty and shall have a warranty period of 90 days from the date of shipment or the remainder of the original warranty period whichever is greater. This warranty and remedy are given expressly and in lieu of all other warranties, expressed or implied, of merchantability or fitness for a particular purpose and constitutes the only warranty made by Lafayette Instrument Company.

Lafayette Instrument Company neither assumes nor authorizes any person to assume for it any other liability in connection with the sale, installation, service or use of its instrumentation. Lafayette Instrument Company shall have no liability whatsoever for special, consequential, or punitive damages of any kind from any cause arising out of the sale, installation, service or use of its instrumentation. All products manufactured by Lafayette Instrument Company are tested and inspected prior to shipment. Upon prompt notification by the Customer, Lafayette Instrument Company will correct any defect in warranted equipment of its manufacture either, at its option, by return of the item to the factory, or shipment of a repaired or replacement part. Lafayette Instrument Company will not be obliged, however, to replace or repair any piece of equipment, which has been abused, improperly installed, altered, damaged, or repaired by others. Defects in equipment do not include decomposition, wear, or damage by chemical action or corrosion, or damage incurred during shipment.

Limited Obligations Covered by this Warranty

1. In the case of instruments not of Lafayette Instrument Company manufacture, the original manufacturer's warranty applies.
2. Shipping charges under warranty are covered only in one direction. The customer is responsible for shipping charges to the factory if return of the part is required.
3. This warranty does not cover damage to components due to improper installation by the customer.
4. Consumable and/or expendable items, including but not limited to electrodes, lights, batteries, fuses, O-rings, gaskets, and tubing, are excluded from warranty.
5. Failure by the customer to perform normal and reasonable maintenance on instruments will void warranty claims.
6. If the original invoice for the instrument is issued to a company that is not the company of the end user, and not an authorized Lafayette Instrument Company distributor, then all requests for warranty must be processed through the company that sold the product to the end user, and not directly to Lafayette Instrument Company.

Export License

The U.S. Department of Commerce requires an export license for any polygraph system shipment with an ULTIMATE destination other than: Australia, Japan, New Zealand or any NATO Member Countries. It is against U.S. law to ship a Polygraph system to any other country without an export license. If the ultimate destination is not one of the above listed countries, contact us for the required license application forms.